

TITLE INTERNAL CORNER FITTING DETAIL

CODE

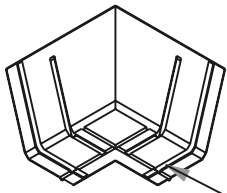

Sealant tape

The GW296 Internal corner tray is used when a horizontal (or refurb) run of trays has to turn through a 90 degree corner

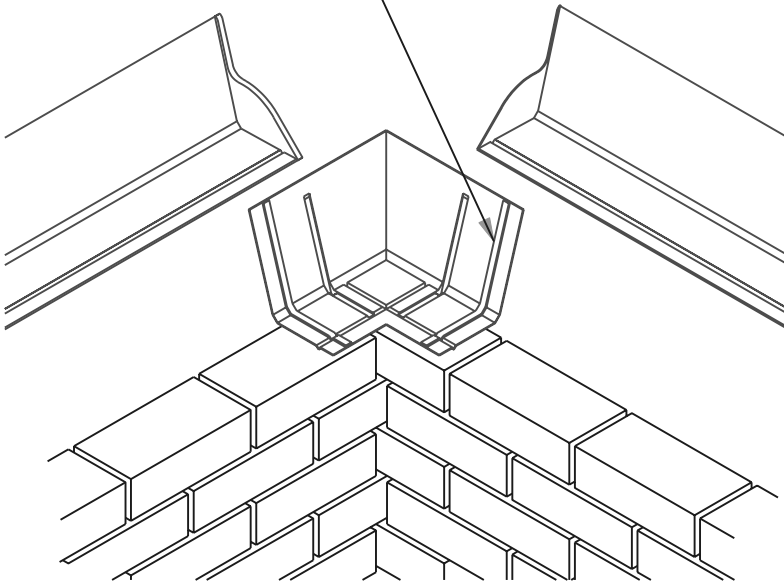

All three trays should be dry and clean. Remove backing from sealant tape place corner tray in position, line up horizontal trays and press firmly into position ensuring a water tight overlapped seal is made between the trays. Lift up the assembled trays and bed down on a thin layer of mortar.

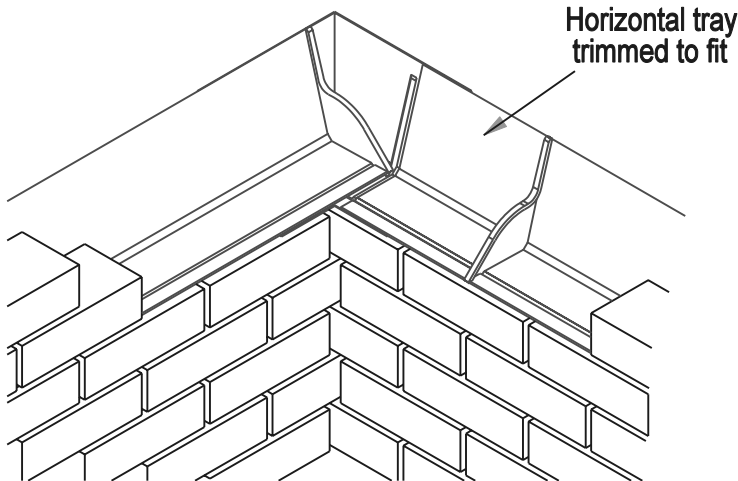

Horizontal tray trimmed to fit

Depending on the detail it may be necessary to cut down the horizontal tray in length to fit at corner details. This should be done using a sharp knife or scissors before sealing to the corner tray.

Note: Mortar is not shown for clarity

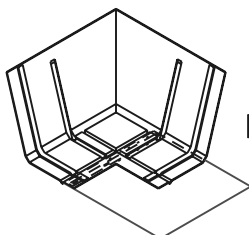

Leaded Tray

### LEADED TRAYS

After fitting the trays and mortar is dry the sealant backing should be removed of the lead. The lead should then be folded into position and tucked in 25mm under the corner tray and dressed as shown. The side which is not stapled should be secured using lead wedges. Pointed using lead sealant.